

3A 103

112

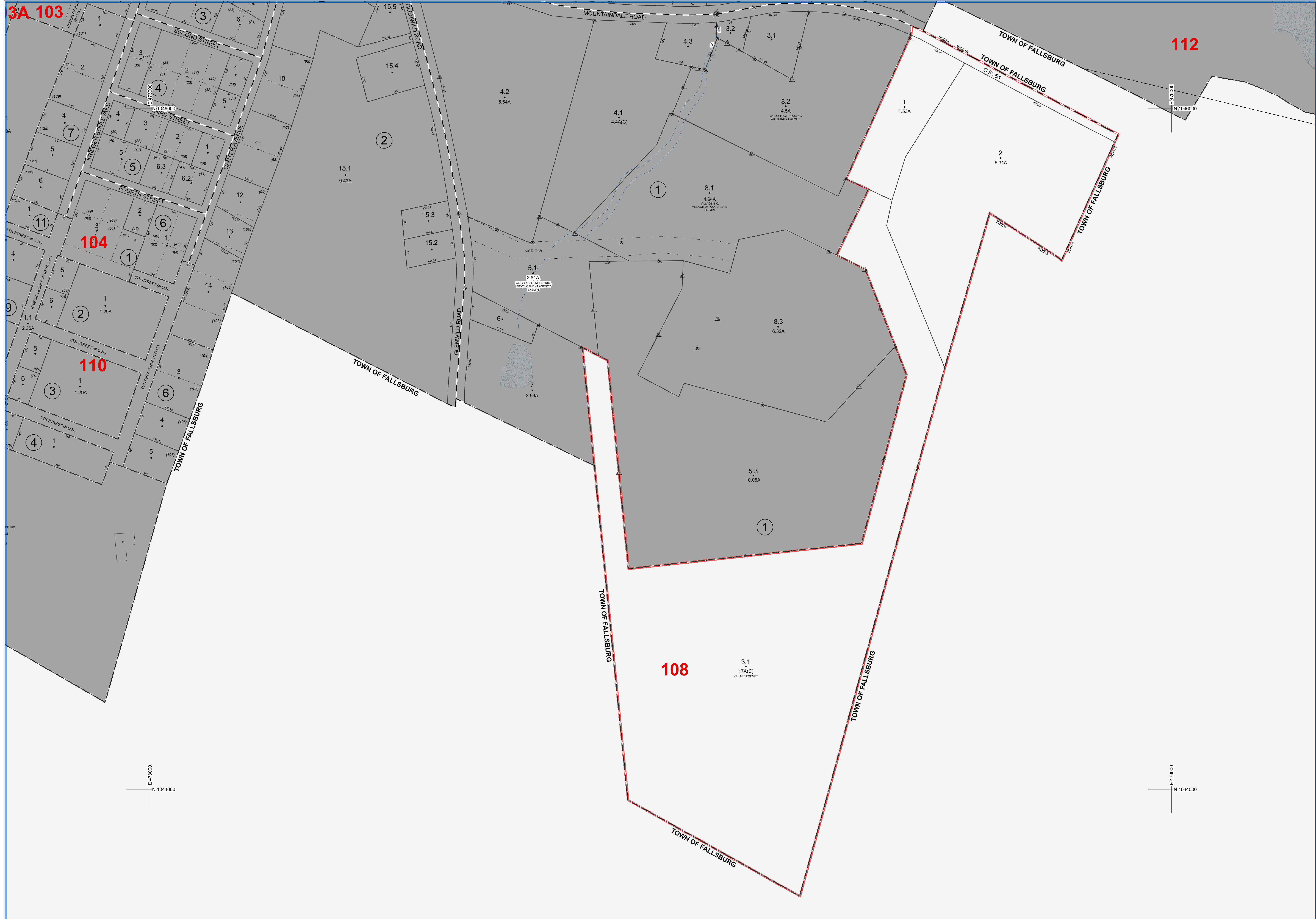

E 473000
N 1044000

E 473000
N 1044000

**SULLIVAN COUNTY
TAX MAP DEPARTMENT**
FOR TAX PURPOSES ONLY
NOT TO BE USED FOR CONVEYANCE
LEGEND APPLIES ONLY TO THE
UNSHADED PORTION OF THE MAP
North American Datum 1983, New York East

 **WEILER MAPPING**
A DIVISION OF JAMES W. SEWELL COMPANY
Owned & Maintained by
Office of Real Property Services
Sullivan County Government Center
100 North St. Monticello, NY 12701
Phone: (845) 807-2221

REVISION TABLE			
DATE	CHANGES	DATE	CHANGES
2/20/1999			
2/20/1999			
5/4/1998			
10/1/1997			
8/31/1995			
1/23/1995			

SPECIAL DISTRICTS							
TYPE	SYMBOL	NAME	ARLM NO.	TYPE	SYMBOL	NAME	ARLM NO.
SCHOOL	SCH	FALLSBURG	482801				
FIRE	FD	WOODRIDGE FIRE DIST.	F0036				
FIRE	FD	MOUNTAINDALE	F0037				
LIGHT	LT	MOUNTAINDALE	LT024				
SEWER	SD	MOUNTAINDALE	SD024				
WATER	WD	MOUNTAINDALE	WD015				

LEGEND			
STATE OR COUNTY LINE	---	TAX MAP BLOCK NO.	(4)
CITY TOWN OR VILLAGE LINE	---	FILED PLAN LOT NO.	(15)
BLOCK LIMIT	---	FILED PLAN BLOCK NO.	(3) (6)
SPECIAL DISTRICT LINE	---	TAX MAP LOT NO.	32
EASEMENT LINE	---	AREA (From Deed)	13.5A
PROPERTY LINE	---	AREA (Calculated)	14.2A(C)
FILED PLAN LOT LINE	---	DIMENSION (From Deed)	14
PATENT LINE	---	DIMENSION (Scaled)	27.5
MATCH LINE	---	STREAM	---

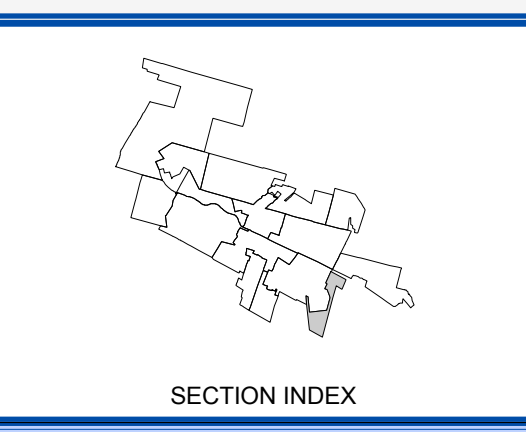

Photo No. 8,241,242,243 Date of Map 4/24/1991
VILLAGE OF WOODRIDGE
 SULLIVAN COUNTY, NEW YORK
 North American Datum 1983, State Plane New York East
 Date of Photo 5/3/1994 Scale 1" = 100'
 Section No. 108